

INFINITY

*The Most
Reliable Port
In Cyprus*

**NEW
SEAFRONT
PROJECT IN NORTH CYPRUS**



TURKISH TITLE DEED

**FULL SEA VIEW FROM
EACH APARTMENT**

Aphrodite Aqua

Park Residence



The Blue Zone Clinic

INFINITY

Aphrodite Beach Front & Spa Residence

Wellness G Blok



Spa & Wellness Center

Γ



Aphrodite Surf Club

INFINITY



LOCATION



Cities

Nicosia:	45 km
Kyrenia:	56 km
Famagusta:	100 km
Lefke:	13 km
Guzelyurt:	6 km
Iskele:	104 km
Paphos:	130 km
Limassol:	88 km
Larnaca:	90 km

Airports

Ercan Airport:	76 km
Larnaca Airport:	97 km
Paphos Airport:	122 km

Universities

Middle East Technical Uni.:	15 km
Girne Amerini.:	48 km
Health and Social Sciences Uni.:	9 km
European University of Lefke:	12 km



Kite Surfing in the West
Year round kite surfing excitement



Old Harbour In Kyrenia
Historical Harbour, Captivating view



Korineum Golf Cluv
An elite golf resort nestled in the tranquil landscapes



Caretta-Caretta at Alagadi Beach
Watch their journey to the sea



Golden Beach
Cleanest sand, untouched beauty



Strawberry Fields In Yedidalga
Taste the fresh fruit harvest



Famafusta Salamis Ruins
Remnants of the Ancient Roman City



Büyük Han in Nicosia
Vibrant local markets, cultural interactions



Trodos Dağları'nda kayak
Kış sporlarının da tadını çıkarın!



The most reliable
Port In Cyprus...

INFINITY residences is a project that embodies every nuance of modern living.

With its aesthetic architecture, functional design, and environmentally conscious approach, INFINITY opens the doors to a peaceful life away from the city's noise.

INFINITY residences stand out not only for their interior spaces but also for their approach to minimizing environmental impact.

The preservation of green spaces and the use of sustainable materials reflect INFINITY's vision of being an environmentally conscious living area.

With its expansive sea views, the integration of green spaces ensures a harmonious connection with nature



INFINITY

offers all the nuances of modern living with its beachfront location, exclusive landscaping, and swimming pools. This unique residential complex opens the doors to a life of luxury, comfort, and tranquility for its residents.

Step into your dream life with
INFINITY!

Open up to a serene environment with
Stunning Views...

The view is the most valuable element that enhances your life from behind the window.

The project focuses on functionality and aesthetics, with every detail designed to simplify your life.

INFINITY





∞ INFINITY

In Every Detail...

Designed with the effective use of natural light in mind, INFINITY has been built to provide you with unparalleled comfort and relaxation.

The project will offer you not just a home, but a lifestyle. From the very first step you take, you will feel as though you have entered an exclusive atmosphere.



Infinity Pool



On the upper floors of both blocks, there are infinity pools.

These specially designed pools create a seamless blend of sky and sea, offering residents a unique experience.

Swimming in the infinity pools becomes an unforgettable experience at sunset and under the stars.



∞ INFINITY

- Situated on an area of 9.500 m²
- With a construction area of 14,361.9 m²
- With 6,380 m² of green space 190 apartments
- Consists of A-B blocks and 12 different apartment options.

The living areas, infinity pool, landscaping, parking, and numerous amenities are integrated into a comprehensive structure, built as a cohesive complex.

LAYOUT PLAN



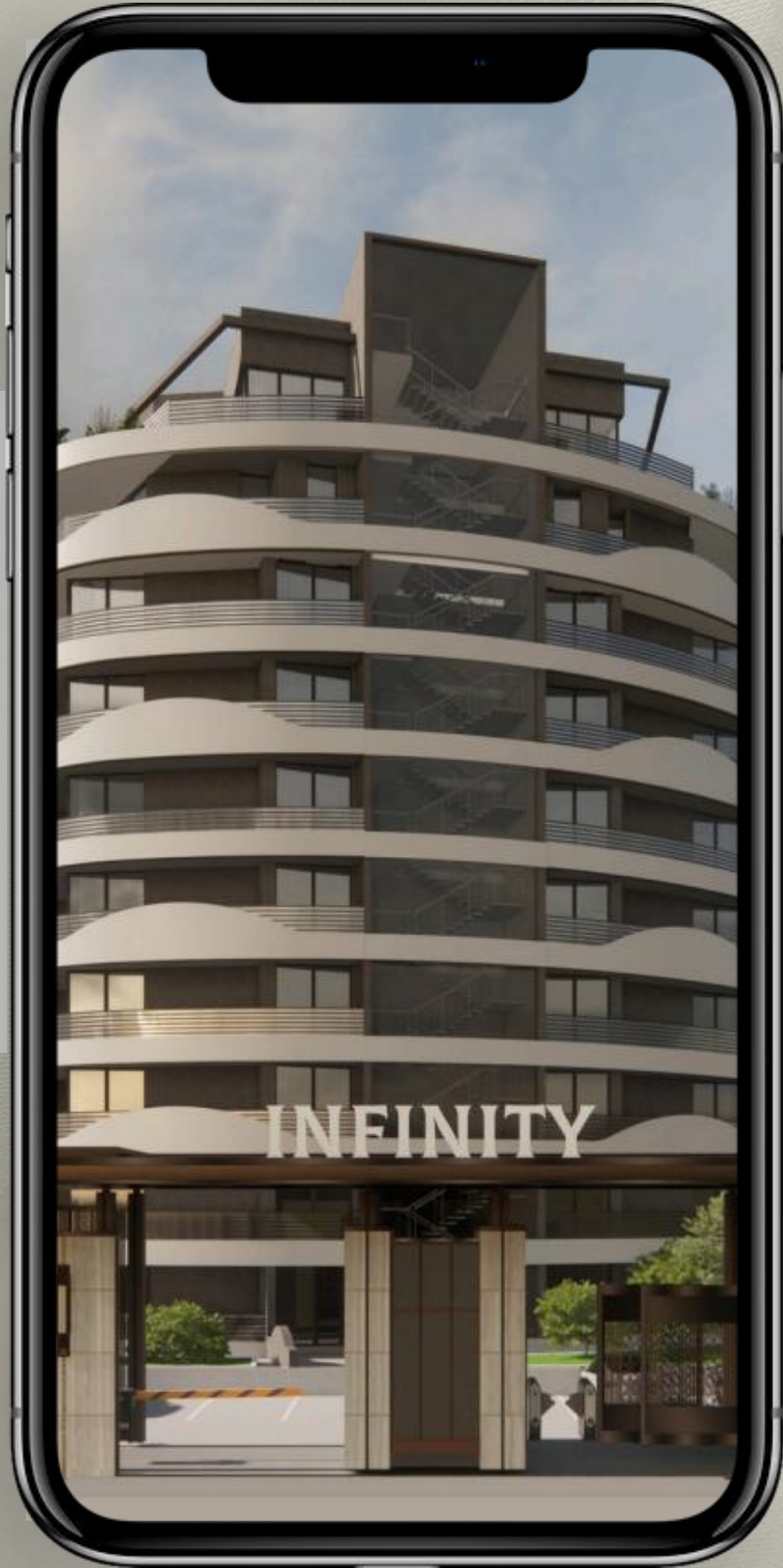

INFINITY

Apartment Types

1+0 Apartment

1 Room

1 Bathroom



1+0 Apartment

Type 1: 64m²



Type 2: 44m²



Starting Price
67.979 GBP

1+0 Apartment

Type 3: 35m²



Type 4: 31m²





1+1 Apartment

1 Living room

1 Bedroom

1 Bathroom



1+1 Apartment

Type 1: 62m²

Type 2: 80m²

Starting Price
111.943 GBP



1+1 Apartment

Type 3: 100m²

Type 4: 115m²

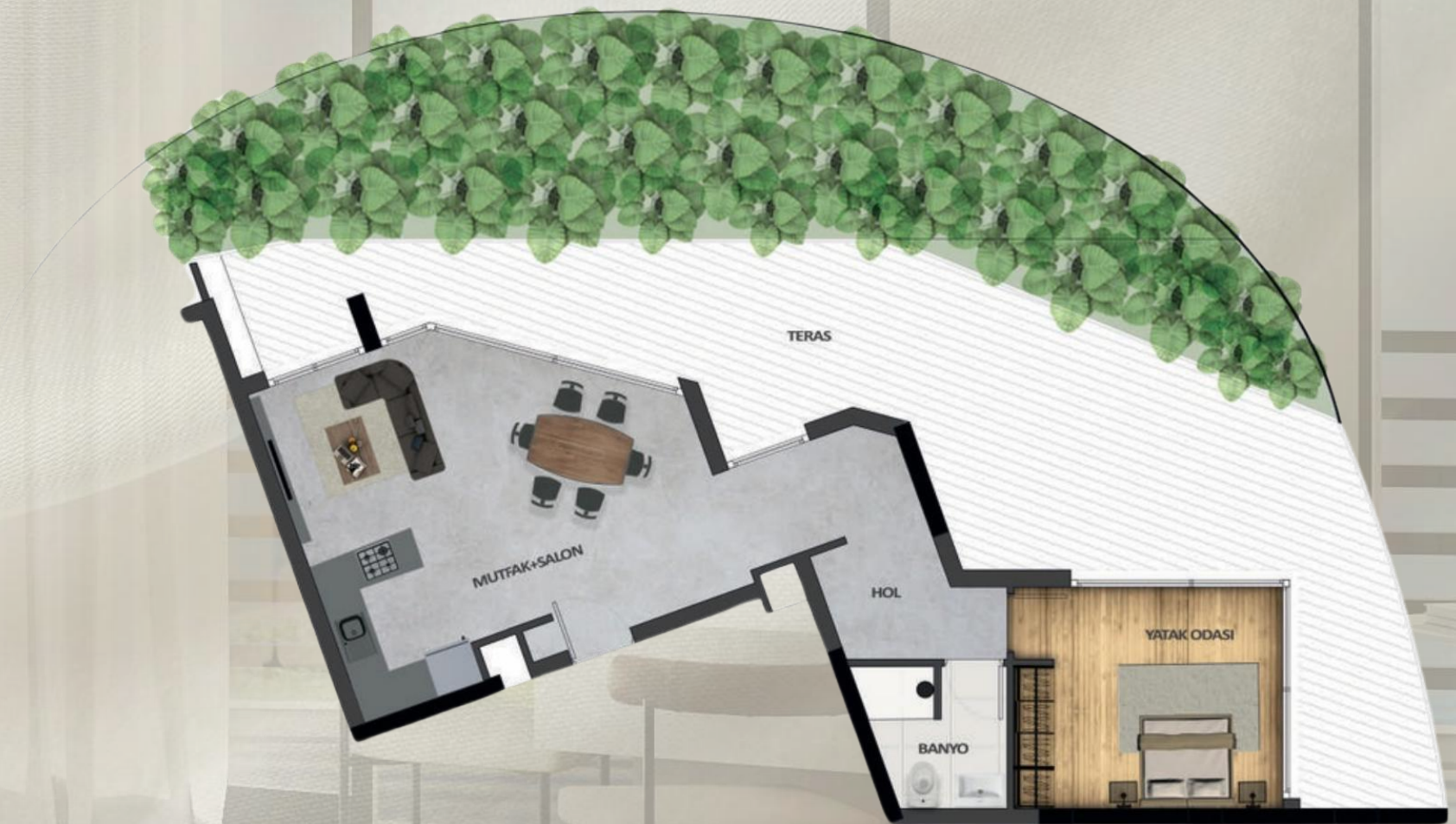

1+1 Apartment

Type 5: 72m²





2+1 Apartment

1 Living room

2 Bedroom

1 Bathroom



2+1 Apartment

Type 1: 100m²

Type 2: 97m²

Starting Price
187.970 GBP



Type 1: 138m²

3+1 Apartment

Starting Price

383.500 GBP



Bathroom



An aerial view of a modern, curved high-rise building with a swimming pool and palm trees. The building is white with curved balconies and is surrounded by a landscaped area with palm trees and a swimming pool. The sky is blue with some clouds. The word "INFINITY" is overlaid in the center in a white serif font.

INFINITY

INFINITY

*SEPARATE
TITLE DEEDS*

*TURKISH
TITLE DEED*

*FIRST SEA
LINE*

*SHORT
APPRECIATION
PERIOD*

STUDIOS									
	RENTAL DAYS	DAILY RATE (Avg.)	BRUT INCOME	NET (%70) INCOME	GBP EXCHANGE	UNIT PRICE	TOTAL UNIT COST	% (RENT /COST)	ROI (YEARS)
Pessimistic	160	€ 60	€ 9.600	€ 6.720	£ 5.645	£ 70.000	£ 70.000	8,06%	12,40
Realistic	180	€ 65	€ 11.700	€ 8.190	£ 6.880	£ 70.000	£ 70.000	9,83%	10,18
Optimistic	200	€ 70	€ 14.000	€ 9.800	£ 8.232	£ 70.000	£ 70.000	11,76%	8,50

INFINITY
by borsa

1+1									
	RENTAL DAYS	DAILY RATE (Avg.)	BRUT INCOME	NET (%70) INCOME	GBP EXCHANGE	UNIT PRICE	TOTAL UNIT COST	% (RENT /COST)	ROI (YEARS)
Pessimistic	160	€ 80	€ 12.800	€ 8.960	£ 7.526	£ 80.000	£ 80.000	9,41%	10,63
Realistic	180	€ 90	€ 16.200	€ 11.340	£ 9.526	£ 80.000	£ 80.000	11,91%	8,40
Optimistic	200	€ 95	€ 19.000	€ 13.300	£ 11.172	£ 80.000	£ 80.000	13,97%	7,16

2+1

	RENTAL DAYS	DAILY RATE (Avg.)	BRUT INCOME	NET (%70) INCOME	GBP EXCHANGE	UNIT PRICE	TOTAL UNIT COST	% (RENT /COST)	ROI (YEARS)
Pessimistic	160	€ 110	€ 17.600	€ 12.320	£ 10.349	£ 180.000	£ 180.000	5,75%	17,39
Realistic	180	€ 125	€ 22.500	€ 15.750	£ 13.230	£ 180.000	£ 180.000	7,35%	13,61
Optimistic	200	€ 130	€ 26.000	€ 18.200	£ 15.288	£ 180.000	£ 180.000	8,49%	11,77

INFINITY
by borsa

PAYMENT PLANS

Option 1

35% down payment,
with the remaining
balance payable
in 36 monthly
installments



Option 2

35% down payment,
with the remaining
balance payable in a
total of 12
installments
every 3 months



Option 3

35% down payment,
with the remaining
balance payable in 36
monthly installments
at
specified intervals



Exclusive For
INFINITY
Interest-free
personalized
payment options
available for you



INFINITY

THE MOST RELIABLE
PORT IN CYPRUS